

PREPARE POWER 3F+T+N SWITCH AUTOMATIC MAGNETOTHERMIC WITH DIFFERENTIAL CURVE "C", Id = 0.3A

Motor	Tension-functioning	Starter	Suggested switch*	Rated current	Current starter
3kW	220 V - 3ph	Direct	3x16A id=0,3A	10	35
	380 V - 3ph	Direct	4x16A id=0,3A	5	22
4kW	220 V - 3ph	Direct	3x20A id=0,3A	16	50
	380 V - 3ph	Direct	4x16A id=0,3A	8	25
5,5kW	220 V - 3ph	Direct	4x25A id=0,3A	22	60
	380 V - 3ph	Direct	4x16A id=0,3A	11	35

MODEL: 500Kg 1000Kg

Date: _____ Signature for approval: _____

MISURE IN mm

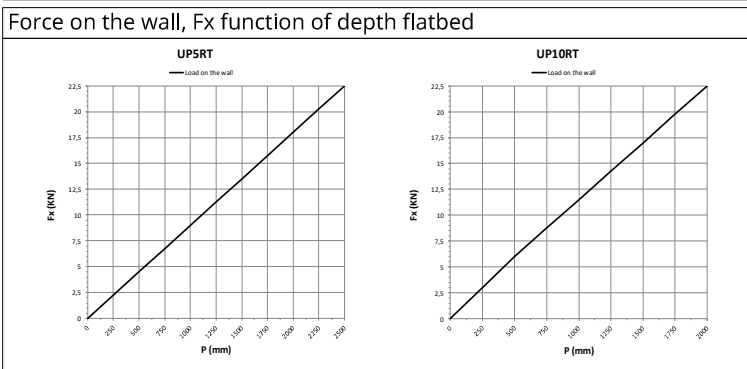
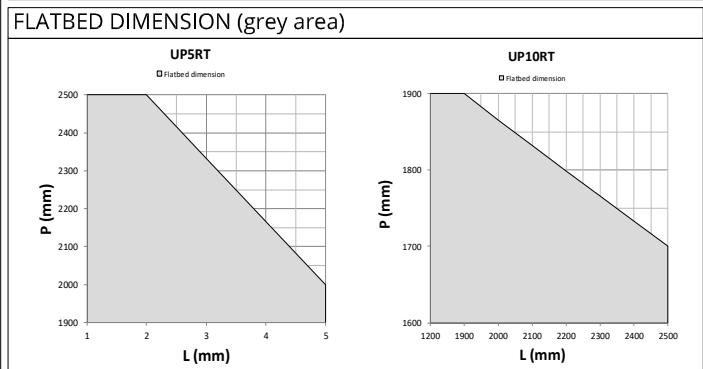

UP DYNAMIC Via Modigliani, 22 - 37045 Legnago (VR) - Tel.0442.59.01.29 - Fax. 0442.59.90.91
www.updynamic.com - e-mail: info@updynamic.com

Q.TA DESCRIZIONE: MODEL: UP5-10RT

STROKE MAX: 12000mm
ONLY FOR GOODS

Cliente: _____
Data: 09/09/19

Disegno n°: TAV-UP5-10RT-STD01

Sostituto dot. _____
Sostitutrice it. _____

Formato A3 Scale

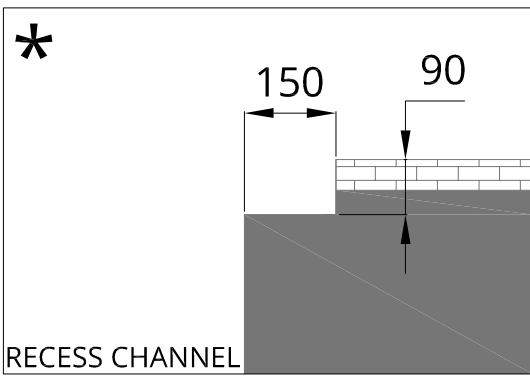

* Predisposition recess channel provided by the customer

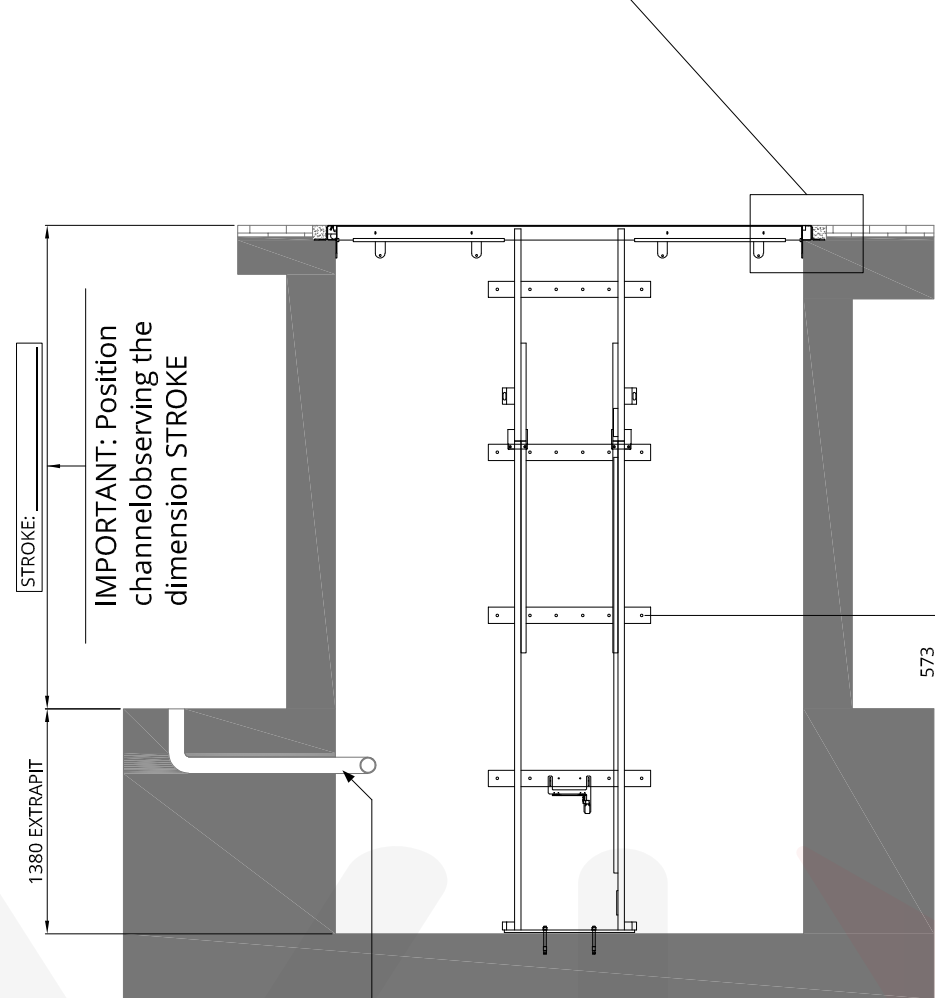
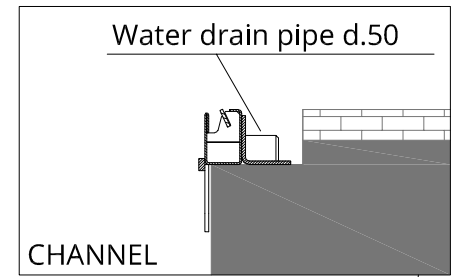
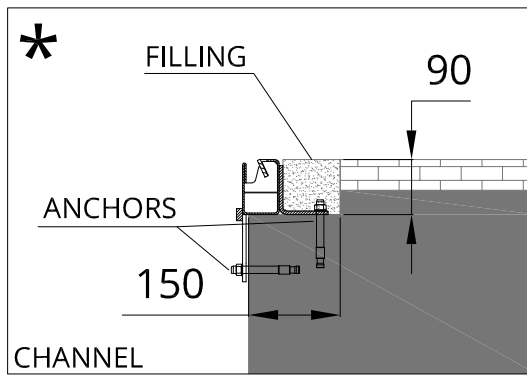

IMPORTANT: Position guides observing the dimension indicated by the channel and check 573 from the downstairs level

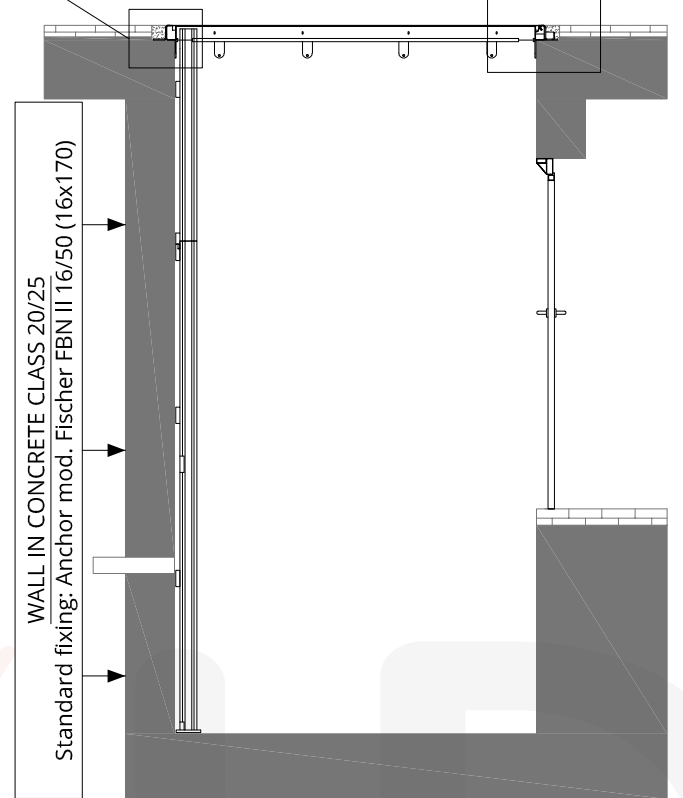
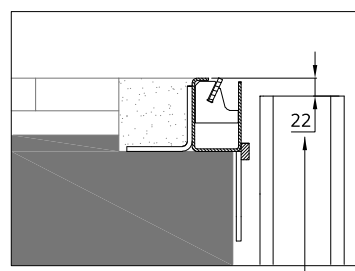

CONCRETE CLASS 20/25

PREPARE CORRUGATED TUBE Ø10cm TO THE TECHNICAL AREA

Water drain pipe d.50

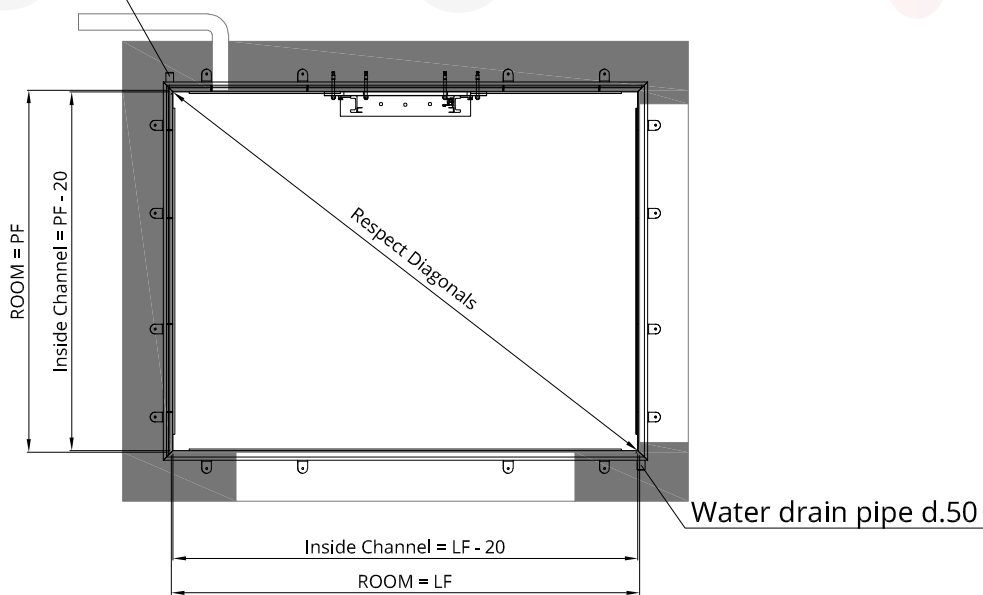

MARK THE ENTRANCES AND THE HEIGHT OF FLOOR

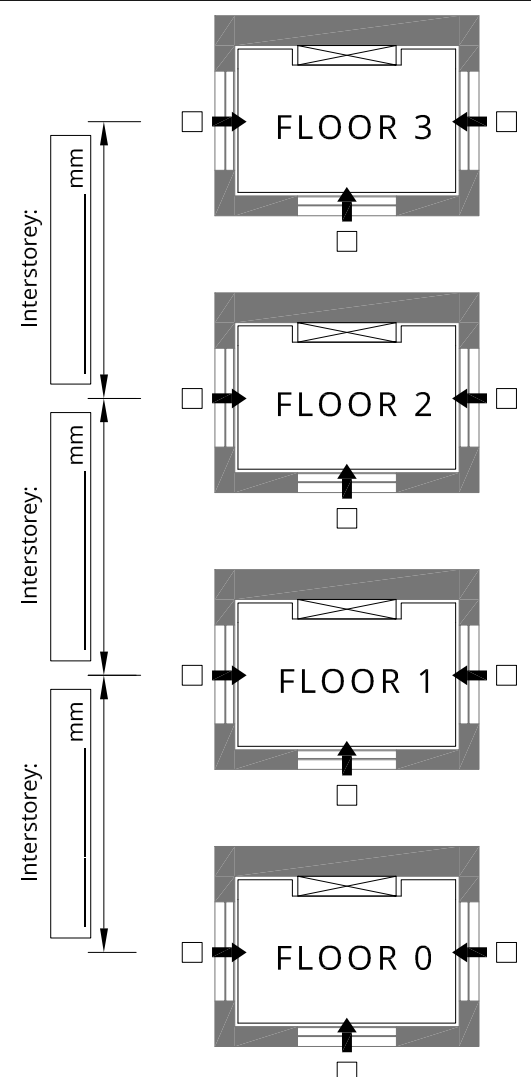

Motor	Tension-functioning	Starter	Suggested switch*	Rated current	Current starter
3kW	220 V - 3ph	Direct	3x16A id=0,3A	10	35
	380 V - 3ph	Direct	4x16A id=0,3A	5	22
4kW	220 V - 3ph	Direct	3x20A id=0,3A	16	50
	380 V - 3ph	Direct	4x16A id=0,3A	8	25
5,5kW	220 V - 3ph	Direct	4x25A id=0,3A	22	60
	380 V - 3ph	Direct	4x16A id=0,3A	11	35

MODEL: 500Kg 1000Kg

Date: _____ Signature for approval: _____

MISURE IN mm

FLATBED DIMENSION (grey area)

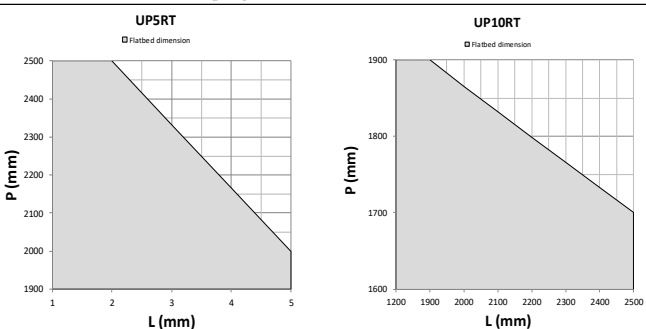

Force on the wall, Fx function of depth flatbed

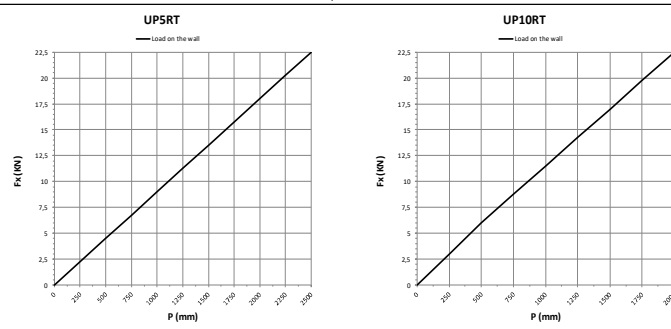

VIVID www.vividlifts.co.uk

Q.TA

VRG 1000

Clijente: _____
 Usergraphic: _____ Data: 09/09/19
 Disegno n.°: _____
 Sostituto dat.: _____
 Sostitutore it.: _____

Formato: A3

Scale